

# CICP2100: Single-Door Surface Mount POE Enterprise Access Controller

**UniVerse 1-Door POE Surface Mount Controller** provides support for two (2) readers on one door, using power over ethernet (PoE) for use on the Continental Enterprise Access System

*- Ideal for mounting on solid wall surfaces cement block &/or masonry.*

Used in the Continental Enterprise access control software environment (CA4K or legacy CA3000), the tamper supervised CICP2100S Power Over Ethernet Controller comes in a durable steel locking enclosure and supports two readers and/or one low current strike via POE. IT-friendly, supports POE or RS485, to downstream 10 controllers on 1 network drop. It can be used networked with, or in place of Continental Enterprise conventional 2-16 Door Super Two® or Accelaterm® Controllers and/or our Networx® or ArchiTech Wireless Access Control Locks.

It accepts Weigand output devices and supports virtually all credential/reader technologies. Proximity, Smart, Biometric, Mobile, Magnetic Stripe, Barcode, Weigand and Keypad readers, as well as those on our Trilogy Networx & ArchiTech wireless Access PIN/Prox Locks, are easily connected and controlled.

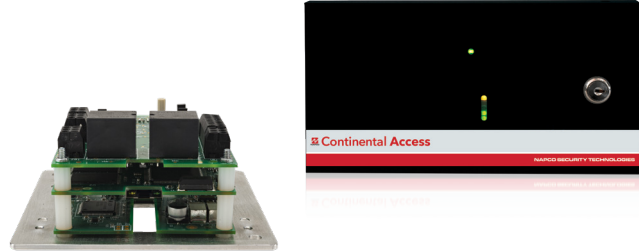

**CICP2100** Also available, model for recessed use in double gang electrical box, including metal faceplate cover with LED indicator status window and connection diagrammed secure self-sleeve. (Measures 2¾" W, 3½" H, 2" D, plus cover plate, 0.5lbs (No Enclosure. Double gang box, not supplied.)

### CICP2100S & CICP2100 Specifications

#### POWER

- POE Onboard Ethernet
- Input Voltage: 12 VDC
- Backup Power: Onboard Memory Database Backup, lithium (CR2032), supplied. Provision for external 4hr. Rechargeable Battery

#### ENVIRONMENTAL

- Operating Temperature: 32 - 120°F (0 - 49°C)
- Storage Temperature: -32 - 149°F (0 - 65°C)

#### PHYSICAL CHARACTERISTICS

- Surface Mount Locking Metal Enclosure, 22 gauge, CRS, 2.3 lbs.
- Dimensions 9.187"W x 5.435"H x 2.18"D
- LED Diagnostics window: 1 Power LED, 5 Ethernet LEDs
- Meets ULC S319 & UL 294; ETL Listed

### Capabilities

- POE Panel Supports 2 Readers for 1 Door
- Supports two Wiegand Readers or one Wiegand and one RS-485 (2-wire) reader
- Super-fast 54MHz RISC Processor
- Supports 200K cards
- 4MB on-board memory
- 1000 Standard transaction buffer, Expandable to 10,000
- 256 Time schedules; 30,000 Access groups; 5x100 Holidays
- 2 Form C Relay outputs, door and auxiliary (MOV-protected)
- Reader & Accessory Power- 320ma @5VDC & 700ma @12VDC
- POE Onboard Ethernet
- High speed 921.6 Kbps baud communication support
- Supports RS-485 Repeat Communications (4-wire)
- 4 Supervised inputs
- Supervised Tamper
- Unsurpassed FIPS/CAC/TWIC performance

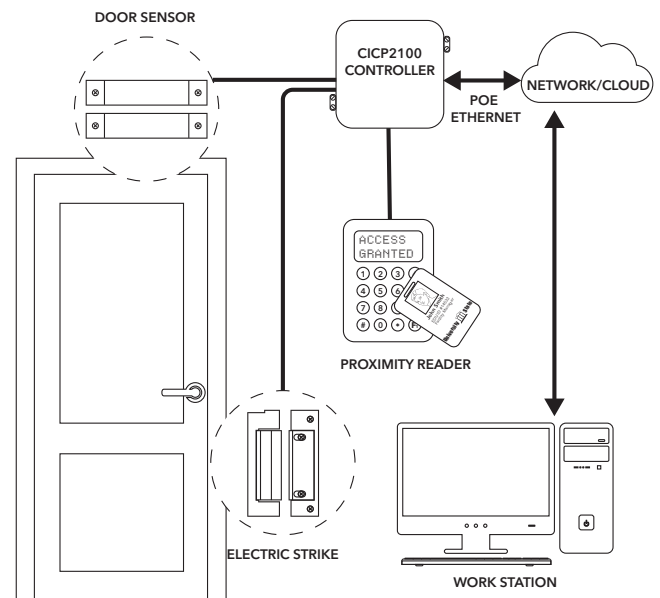

NAPCO ACCESS PRO, Continental Enterprise, uniVerse, Trilogy & Networx are trademarks of NAPCO Security Technologies, Inc. Other marks remain intellectual property of their respect\* Supports varying versions Continental Enterprise (Enterprise, CA4K, legacy CA3000, consult tech docs.)